

Client \_\_\_\_\_ Quantity \_\_\_\_\_  
Project \_\_\_\_\_ Position \_\_\_\_\_

## Pass-Through

Model: J110/2M

Cod: J12110200201

Pass-Through refrigerated cabinet for GN2/1 trolleys, 2 doors. Plug-in refrigeration unit, 5 heavy duty climatic class and R290 ecological refrigerant gas. Led lighting, snap handle with lock and key as standard. Temperature range - 2°+8°C with ventilated refrigeration hot gas defrost. 75 mm insulation thickness - HFO with high insulation performance and low environmental impact (CFC, HCFC, HFC free); easily replaceable triple chamber magnetic gasket. One-piece structure, interior/exterior AISI 304 stainless steel, exterior galvanised steel back. Rounded inner corners for easy cleaning. Replaceable refrigerant system FSS - Fast Service System - for quick and easy service. Predisposed for connection to Cosmo remote supervision system and ModBus/RTU Rs485 connection.



## Technical data

Gross capacity:	838 lt
Temperature range:	-2°+8°C
Refrigerant unit:	Plug-in
Climate class:	5
Cooling gas:	R290 (GWP=3)
Defrost:	Hot gas
Valve:	Supplied standard with solenoid
Dimensions:	810×880×2115 mm
Packing dimensions:	840×920×2260 mm
Net / gross weight:	140 Kg / 160 Kg
Net / gross volume:	353 lt / 838 lt
Voltage:	220-240 V - 50 Hz
Total rate:	390W - 1,8A
Cooling capacity:	713 W*
*:	Evap. -10°C Cond. +55°C

## Features

Standard equipment:	LED lighting, lock with key
Control:	Electronic, display flush with the panel
Doors:	2 doors, self-closing with a 105° stop, right hinged
Door gasket:	Magnetic, triple chamber and easily replaceable
Insulation:	75 mm thickness - CFC/HCFC free
Exterior/interior finishing:	Exterior and interior AISI 304 stainless steel. Back in galvanized steel
Inner corners:	Rounded for easy cleaning and ensuring maximum hygiene
Handle:	Snap-in chrome with integrated lock
Cosmo:	Predisposed for Cosmo Hub connection

## Accessories and variants

Alimentazione frequenza 60Hz

Trolley GN2/1 20 trays 598x660x1630 mm

Other special voltage

Cosmo cable connection kit

## COSMO - wi-fi control

Cosmo is The Nice Kitchen's exclusive Wi-Fi technology that allows Coldline, Modular and Nevo appliances to be connected and monitored from a smartphone. The cabinet, connected with Cosmo kit via cable to a Cosmo hub (MODI, VISION, THAW.PRO, LEVTRONIC, QUBI) or with Cosmo Wi-Fi kit, can be monitored by the CosmoApp and receive alerts in case of abnormal operation.

## Technical draw

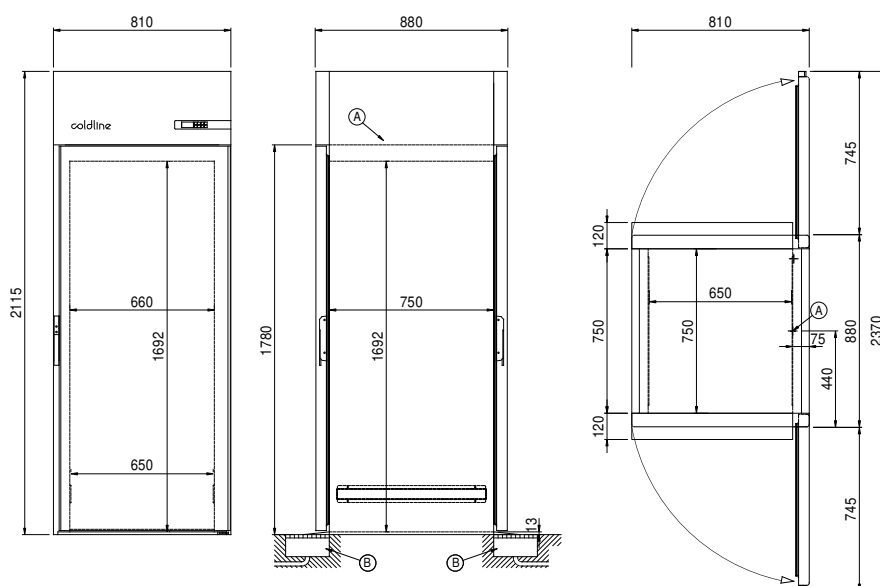

A: Power supply cable outlet

B: Condensation water drain