

Client \_\_\_\_\_ Quantity \_\_\_\_\_

Project \_\_\_\_\_ Position \_\_\_\_\_

## Pass-Through

Model: J110/2MV1

Cod: J12110200301



### Technical data

Gross capacity:	838 lt
Temperature range:	-2°+8°C
Refrigerant unit:	Plug-in
Climate class:	4
Cooling gas:	R290 (GWP=3)
Refrigerant Charge:	350g
Defrost:	Hot gas
Valve:	Supplied standard with solenoid
Dimensions:	810×880×2115 mm
Packing dimensions:	840×920×2260 mm
Net / gross weight:	160 Kg / 180 Kg
Net / gross volume:	353 lt / 838 lt
Voltage:	220-240 V - 50 Hz
Total rate:	390W - 1,8A
Cooling capacity:	713 W*
*:	Evap. -10°C Cond. +55°C

### Features

Standard equipment:	LED lighting
Control:	Electronic, display flush with the panel
Doors:	1 aluminium door, self-closing with 105° latch, right-hand hinges
Door gasket:	Magnetic, triple chamber and easily replaceable
Insulation:	75 mm thickness - CFC/HCFC free
Exterior/interior finishing:	Exterior and interior AISI 304 stainless steel. Back in galvanized steel
Inner corners:	Rounded for easy cleaning and ensuring maximum hygiene
Handle:	Snap-in chrome with integrated lock
Cosmo:	Predisposed for Cosmo Hub connection

## Accessories and variants

Alimentazione frequenza 60Hz

Trolley GN2/1 20 trays 598x660x1630 mm

Other special voltage

Cosmo cable connection kit

## COSMO - wi-fi control

Cosmo is The Nice Kitchen's exclusive Wi-Fi technology that allows Coldline, Modular and Nevo appliances to be connected and monitored from a smartphone. The cabinet, connected with Cosmo kit via cable to a Cosmo hub (MODI, VISION, THAW.PRO, LEVTRONIC, QUBI) or with Cosmo Wi-Fi kit, can be monitored by the CosmoApp and receive alerts in case of abnormal operation.

## Technical draw

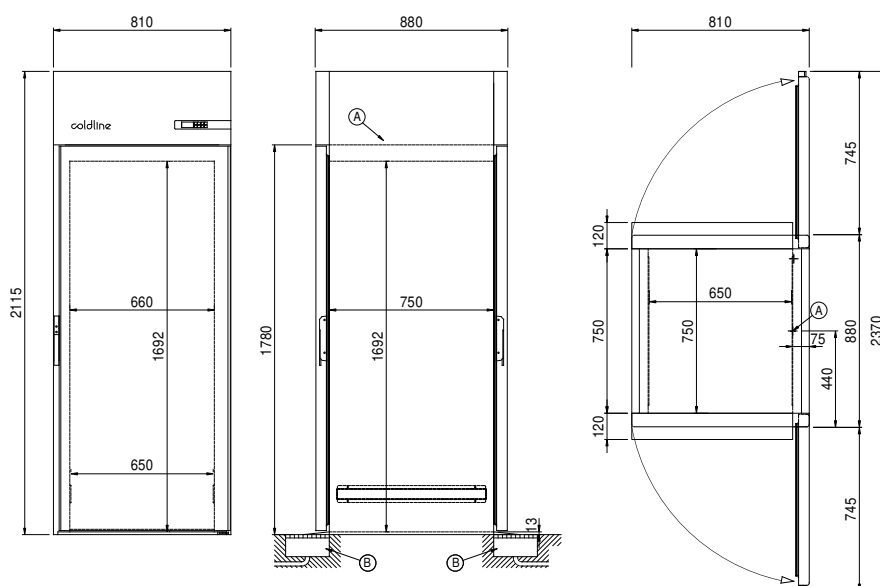

A: Power supply cable outlet

B: Condensation water drain