

Client \_\_\_\_\_ Quantity \_\_\_\_\_

Project \_\_\_\_\_ Position \_\_\_\_\_

## Arkis GN counter 3 doors

Model: HS17/1BR-SVT200-760

Cod: H80330000402



### Technical data

|                     |                                 |
|---------------------|---------------------------------|
| Top:                | Without top                     |
| Gross capacity:     | 476 lt                          |
| Temperature range:  | -15°-22°C                       |
| Refrigerant unit:   | remote                          |
| Cooling gas:        | R452a (GWP=2.141)               |
| Defrost:            | Electric                        |
| Body height:        | 760 mm                          |
| Valve:              | Supplied standard with solenoid |
| Dimensions:         | 1570×655×860 mm                 |
| Packing dimensions: | 1875×800×998 mm                 |
| Net / gross weight: | 124 Kg / 134 Kg                 |
| Net / gross volume: | 300 lt / 476 lt                 |
| Voltage:            | 220-240 V - 50-60 Hz            |
| Total rate:         | 945W - 4,3A                     |
| Cooling capacity:   | 540 W*                          |
| *:                  | Evap. -30°C Cond. +55°C         |

### Features

|                              |  |
|------------------------------|--|
| Standard equipment:          | 3 slides, 3 plastic coated GN1/1 shelves   |
| Control:                     | Electronic, display flush with the panel   |
| Doors:                       | 3 doors with 180° opening  |
| Door gasket:                 | Magnetic, triple chamber and easily replaceable                                    |
| Insulation:                  | 60 mm thickness - CFC/HCFC free  |
| Exterior/interior finishing: | Exterior interior and back in AISI 304 stainless steel. Base in colaminated steel. |
| Inner corners:               | Rounded for easy cleaning and ensuring maximum hygiene                             |
| Handle:                      | Stainless steel AISI 304, 2 mm thick   |
| Racks and slides:            | Stainless steel AISI 304   |
| Feets:                       | AISI 304 stainless steel adjustable h 100/150 mm                                   |
| Cosmo:                       | Predisposed for Cosmo Hub connection   |

### Remote unit technical data

|                            |                         |
|----------------------------|-------------------------|
| Voltage:                   | 220-240 V - 50 Hz       |
| Assorbimento Unità Remota: | 650W - 3,0A             |
| Cooling gas:               | R452A                   |
| Gross weight:              | 25,7 Kg                 |
| Dimensions:                | 500×330×295 mm          |
| Pipe delivery:             | Ø 3/8"                  |
| Pipe suction:              | Ø 3/8"                  |
| Packing dimensions:        | 540×345×310 mm          |
| Cooling capacity:          | Evap. -30°C Cond. +55°C |

### COSMO - wi-fi control

Cosmo is The Nice Kitchen's exclusive Wi-Fi technology that allows Coldline, Modular and Nevo appliances to be connected and monitored from a smartphone. The counter, connected with Cosmo kit via cable to a Cosmo hub (MODI, VISION, THAW.PRO, LEVTRONIC, QUBI) or with Cosmo Wi-Fi kit, can be monitored by the CosmoApp and receive alerts in case of abnormal operation.

### Technical draw

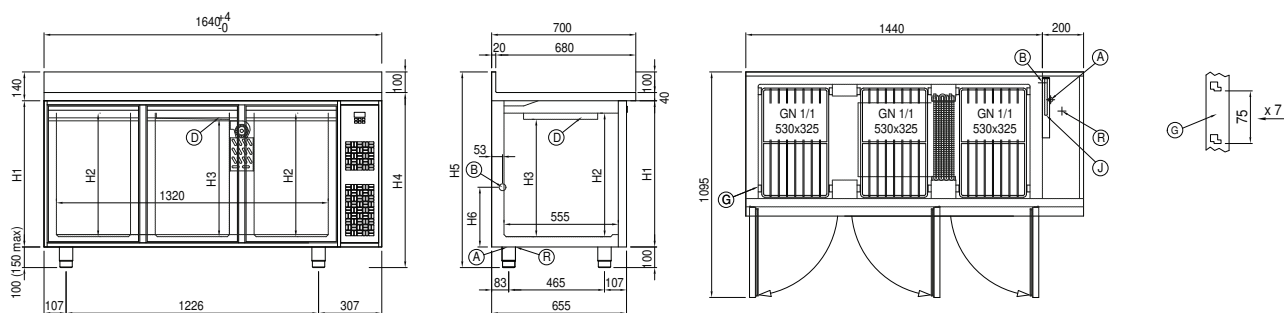

- |                              |  |                     |
|------------------------------|--|---------------------|
| A: Power supply cable outlet | B: Condensation water drain                  | D: Airflow conveyor |
| G: Racks pitch               | J: Automatic evaporation of condensing water | R: Gas output pipes |

In order to constantly offer the best possible products we reserve the right to make changes on technical specifications without incurring any obligation for equipment previously or subsequently sold.