

Client _____ Quantity _____

Project _____ Position _____

Pastry EN60x40 counter 4 doors

Model: TS21/1BJ-760

Cod: T20400000402



Technical data

| | |
|--------------------------|---------------------------------|
| Top: | Without top |
| Temperature range: | -15°-22°C |
| Refrigerant unit: | Plug-in |
| Energetic class: | E |
| Energy efficiency index: | 84,8 |
| Annual consumption: | 4776 kW/h annum |
| 24h consumption: | 13,085 kW/h/24h |
| Climate class: | 5 |
| Cooling gas: | R290 |
| Defrost: | Hot gas |
| Body height: | 760 mm |
| Valve: | Supplied standard with solenoid |
| Dimensions: | 2560×780×860 mm |
| Packing dimensions: | 2655×900×998 mm |
| Voltage: | 220-240 V - 50 Hz |
| Cooling capacity: | 569 W* |
| *: | Evap. -30°C Cond. +55°C |

Features

| | |
|------------------------------|--|
| Standard equipment: | 16 slides EN60x40 |
| Control: | Electronic, display flush with the panel |
| Doors: | 4 doors, self-closing, reversible with 105° stop |
| Door gasket: | Magnetic, triple chamber and easily replaceable |
| Insulation: | 60 mm thickness - CFC/HCFC free |
| Exterior/interior finishing: | Exterior interior and back in AISI 304 stainless steel. Base in colaminated steel. |
| Inner corners: | Rounded for easy cleaning and ensuring maximum hygiene |
| Handle: | Stainless steel AISI 304, 2 mm thick |
| Racks and slides: | Stainless steel AISI 304 |
| Feets: | AISI 304 stainless steel adjustable h 100/150 mm |
| Cosmo: | Predisposed for Cosmo Hub connection |

Accessories and variants

| | |
|------------------------------------|--|
| Drawers 1/2 | Service water sink Ø 300 mm |
| Drawers 1/3 | Single lever mixer hole Ø 3/4 |
| Drawers 1/3 + 2/3 | Adjustable feet h 145/195 mm |
| Technical compartment on the left | 6 Swivel and brake castors h 128 mm |
| Lock with key for drawer 1/2 | Aluminium coated backingan EN60x40 h 20 mm |
| Lock with key for drawer 1/3 | Stainless steel shelf EN60x40 |
| Lock with key for drawer 1/3 + 2/3 | Plastic coated shelf EN60x40 |
| RAL customisable colouring | Pair of type L slides 605 mm |
| Plug-in water unit | IP44 schuko socket with cover |
| Alimentazione frequenza 60Hz | Serial interface, RS485 cable |
| Other special voltage | Cosmo cable connection kit |
| Internal hygiene H3 | Removable plinth EN 4D h 50 mm |
| Granite flat worktop | Removable plinth EN 4D h 100 mm |
| Granite worktop with splashback | Removable plinth EN 4D h 150 mm |

COSMO - wi-fi control

Cosmo è la tecnologia wi-fi che permette di connettere e monitorare da smartphone gli apparecchi Coldline. Collega i tavoli Pastry ad un Cosmo hub (MODI, VISION o LEVTRONIC) e dall'app potrai controllare le condizioni di funzionamento di ogni macchina e ricevere alert in caso di funzionamento anomalo.

Technical draw

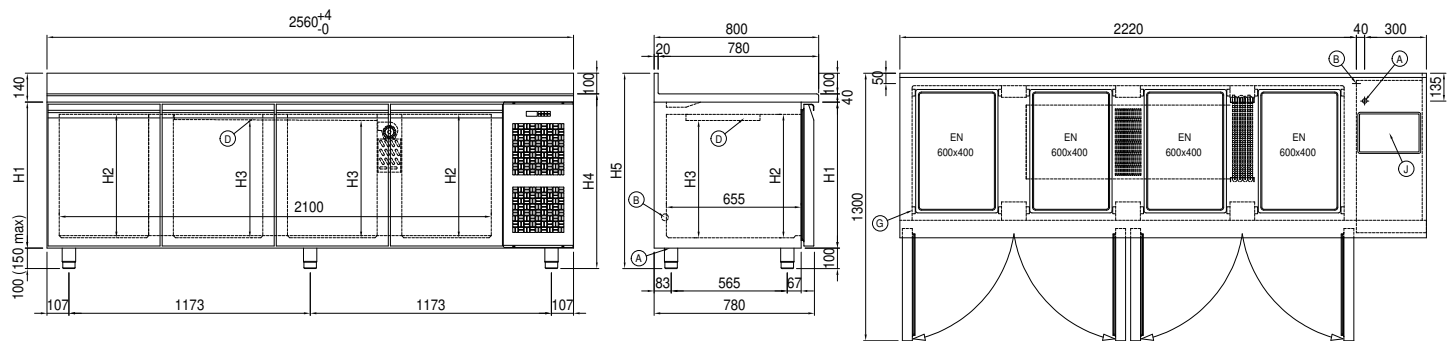

- | | | |
|------------------------------|--|---------------------|
| A: Power supply cable outlet | B: Condensation water drain | D: Airflow conveyor |
| G: Racks pitch | J: Automatic evaporation of condensing water | |